

OWNER'S MANUAL

WARNING

WARNING: Carefully read and understand this entire manual before operating or installing this product. Failure to follow these instructions can result in serious injury to yourself or to others.



P_{ower} O_n D_{emand} **Powered Adjustment System**

MODEL NUMBER

B2610

1A-6303-01

Thank you for purchasing our basketball system. We try hard to ensure that our products are of high quality and free of manufacturing defects and of missing parts. However, if you have any problems with your basketball pole, such as a manufacturing defect or a missing part, please **DO NOT RETURN IT TO THE STORE**. Call us at:

TOLL FREE 1-888-USA-GOAL

(THIS IS A CONSUMER ONLY NUMBER)

FAX: (812) 467-1399

Or write us at:

CUSTOMER SERVICE DEPT., P.O. Box 889, Evansville, IN 47706

Please provide model number, serial number, and/or part number of the product and/or part when you call or write. These numbers can be found on the product, packaging, or in this owner's manual.

ESCALADE[®] **S P O R T S**

Please visit our World Wide Web site at:

<http://www.escaladesports.com>

Do not tighten hardware until instructed to do so. If hardware is tightened too soon, mounting holes may not align and parts may not fit together. Leave locknuts slightly loose until you are instructed to tighten them.

Read this manual all the way through before starting installation. Then read each step completely before beginning that step.

SAFETY INSTRUCTIONS



The purpose of safety symbols is to attract your attention to possible dangers. The safety symbols, and the explanations with them, deserve your careful attention and understanding.



WARNING: Failure to obey a safety warning can result in serious injury to yourself or to others. Always follow the safety precautions to reduce the risk of fire, electric shock and personal injury.



WARNING: Carefully read and understand this entire manual before operating or installing this product. Save this manual! Owner must ensure anyone to operate this product first read and understand this entire manual.

SAFETY INSTRUCTIONS

- **CHECK FOR DAMAGED PARTS.** Before each use, check product for damaged parts.
- **ONLY USE CHARGER PROVIDED WITH THIS PRODUCT.** Use of another charger could cause batteries to burst causing possible serious injury.
- **DO NOT CHARGE BATTERY IN DAMP OR WET LOCATION.**
- **DO NOT CHARGE BATTERY IN EXTREME CONDITIONS.** Battery should be charged in a location where temperature is more than 50°F and less than 100°F.
- Under extreme usage or temperature conditions, battery leakage may occur. If liquid comes in contact with your skin, wash immediately with soap and water, then neutralize with lemon juice or vinegar. If liquid gets in your eyes, flush them with clean water for at least 10 minutes, then seek immediate medical attention.
- Before using battery charger, read all instructions and cautionary markings in this manual.



WARNING: To reduce risk of injury, charge only the battery provided with this product or replacement battery provided by Escalade Sports. Other batteries may burst causing serious personal injury and damage.

- Do not expose charger to rain or snow.
- Make sure cord is located so that it will not be stepped on, tripped over, or otherwise subjected to damage or stress.
- Do not operate a charger with a damaged cord or plug. If damaged have replaced by a qualified serviceman.
- Do not use a charger if it has received a sharp blow, been dropped or has been damaged in any way. Take it to a qualified serviceman.
- Do not disassemble charger; take it to a qualified serviceman when service or repair is needed. Incorrect reassembly may result in risk of electric shock or fire.
- Disconnect charger from power supply when not in use.
- Do not adjust unit above 10 feet or below 7-1/2 feet. Adjusting height outside of this range may damage unit.

POD INSTALLATION

1. Match your unit up to one of the drawings to decide which set of POD Brackets to use.
2. Attach POD Brackets (#2) to top of POD using four screws (#3), lockwashers (#4) and washers (#5). Tighten screws tight. See Figure 2.

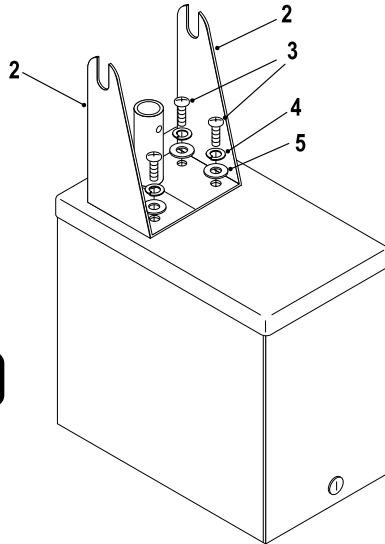

Figure 2

3. Lower system until Board Arms rest on safety stops. See Figure 3.
4. If Actuator Handle is attached to actuator remove pull pin and then remove Actuator Handle. **NOTE: Put Actuator Handle in a safe place. It may be needed if adjustment is necessary while battery is charging.**
5. Loosen, **DO NOT REMOVE**, bolts securing actuator to post ears. See Figure 4.
6. Slide POD brackets between flatwasher and plastic washer. Secure POD Coupler to actuator by inserting Pull Pin (#5). See Figure 4.
7. Tighten bolts securing Actuator tight.

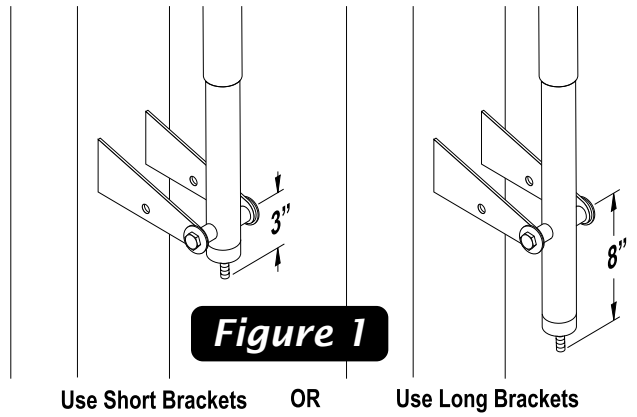

Figure 1

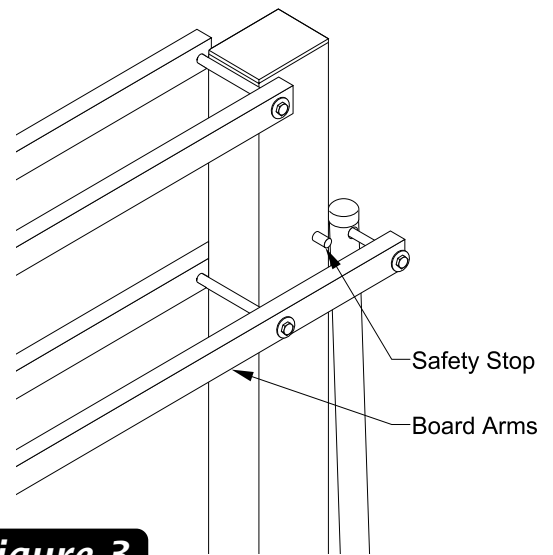

Figure 3

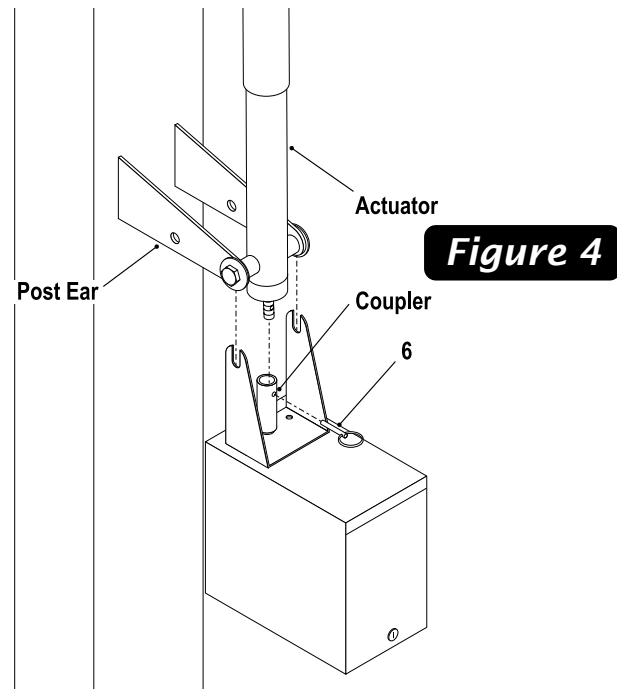

Figure 4

REPLACEMENT PARTS

Key#	Part #	Description	Qty.
1	1A-6303-01	POD KIT	1
2	2S-6435-00	Short POD Bracket (set of 2)	1
	2S-6448-00	Long POD Bracket (set of 2)	
3	1B-6466-00	1/4"-20 x 5/8" Bolt	4
4	2B-6022-01	1/4" Split Lockwasher	4
5	801-9B	1/4" Flat Washer Black	4
6	7B-6255-00	Pull Pin	1
7	3E-6027-00	7 AMP Fuse	1
8	4A-6578-00	Lockset	1
9	3E-6028-00	Battery Pack	1

OPERATION

Unit Operation

Push on the bottom of the Up/Down switch to lower the unit. Push on the top of the Up/Down switch to raise the unit.

IMPORTANT! Do not adjust unit above 10 feet or below 7-1/2 feet. Adjusting height outside of this range may damage unit.

If your unit stops working suddenly check fuse located in switch panel. If necessary replace fuse with a 7 amp fuse. **Using a fuse other than a 7 amp fuse can result in damage to your system and will void your warranty.**

To prevent unwanted use of your POD system keep access door locked at all times.

Charging Battery

IMPORTANT! Do not store batteries in discharged state. Recharge batteries after every 30 cycles.

1. Pull battery out of battery compartment.
2. Unplug battery connector from POD.

IMPORTANT! Do NOT store battery in POD during cold weather. Store batteries near room temperature in a dry place.

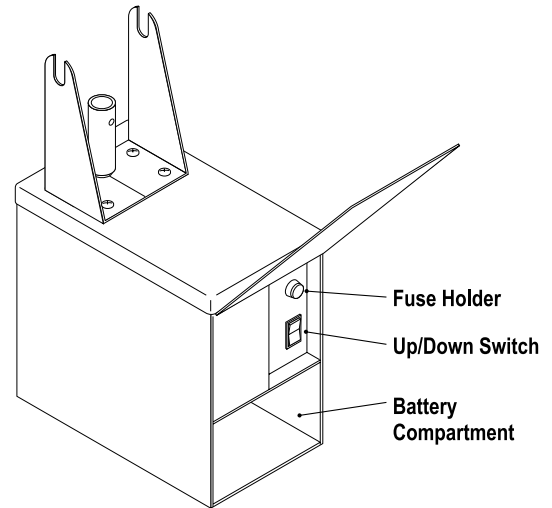

IMPORTANT! Make sure power supply is normal house voltage, 120 volts, 60Hz, AC only.

3. Plug battery into charger. Red light should turn on. If green light turns on, battery is already charged.
4. Allow battery to charge until green light on charger turns on.

IMPORTANT! Do NOT continue charging after green light turns on. Charge cycle is approximately 10 hours. Charge cycle varies depending on extent of charge left in battery.

LIMITED WARRANTY

Subject to proper installation and normal use, Escalade Sports warrants, subject to the limitations below, to the original retail purchaser all components of the POD System to be free of defects in material and workmanship for the period of one year from the date of purchase by the original retail purchaser.

Merchandise must be shipped prepaid with a copy of proof of purchase to our factory for examination to see whether it needs to be repaired or replaced. Any labor costs, travel expenses and any other changes involved in the removal, installation or replacement of the defective/repared parts from/to your POD System will be your (the purchaser's) responsibility. Shipping charges for replaced or warranted merchandise being sent back to the customer from our factory must be prepaid by the customer in advance. If not, the replacement shipment will be sent out collect.

Escalade Sports reserves the right to examine photographs or physical evidence of merchandise claimed to be defective, and to recover said merchandise, prior to authorization of warranty claims. A "Returned Goods Authorization" number may be required, please call for details prior to the return of any photographs or merchandise.

This warranty is expressly in lieu of all warranties, expressed or implied, including warranties of merchantability or fitness for use. Escalade Sports does not assume or authorize any person or representative to assume for us, any other liability in connection with the sale of our products.

The remedy of repair or replacement stated above is our exclusive remedy. Escalade Sports will not be liable for any other damages or expenses which may incur, including but not limited to incidental or consequential damages. Escalade Sports assumes no other obligations or liability on the part of the purchaser, and Escalade Sports neither assumes nor authorizes any other person to assume for it any other liability in connection with the goods sold.

What is Not Covered by This Warranty

- Any merchandise subjected to abuse, negligence, improper installation, vandalism, acts of God, alteration of product, or any other events beyond the control of Escalade Sports.
- Paint or rusted parts. Paint kits will be available to assist in normal maintenance.
- Shipping charges both ways. Note: Any merchandise shipped to Escalade Sports collect will be refused.
- Dealer service charges, labor charges and travel expenses associated with replacement of repair of warranty item.

WARRANTY GUIDELINES

1. Keep your proof of purchase (original retail purchaser). Without it, we will not be able to proceed with any warranty service.
2. Call or write Escalade Sports Inc. to receive a Return Authorization # and allow us to better guide you with your specific needs.

1-888-USA-GOAL / Warranty Dept.

Or Write us at:

Escalade Sports Inc. - P.O. Box 889, Evansville, IN 47706 - Attn: Warranty Dept.

Or E-mail us at: customerservice@escaladesports.com